



**4/35 Sandy Beach Road Korora NSW**

2  1  1 

Located a short 90 metre walk to the beach at Korora Bay is this tidy two bedroom unit that presents a great opportunity to both investors and owner-occupiers alike.

The unit features a neutral kitchen inclusive of stainless steel appliances, an original bathroom that is tidy, ceiling fans throughout and a covered front patio overlooking the garden from the top level.

Korora is a highly sought after address, only minutes to major shopping centre, tourist attractions and with popular primary school nearby...if it's all about the neighbourhood and lifestyle on offer then this property will appeal.

Car accommodation is a single carport tucked behind the

[For full version visit the website](https://www.aletacorealty.com/sale/nsw/mid-north-coast/korora/residential/unit/7232272)

**Type** : Unit  
**Price** : \$ 530,000  
**Land Size** : 106 sqm  
**View** : <https://www.aletacorealty.com/sale/nsw/mid-north-coast/korora/residential/unit/7232272>



**Aleta Stephens**  
 (02) 6638 9311



**Whitney Stephens**  
 (02) 6638 9311

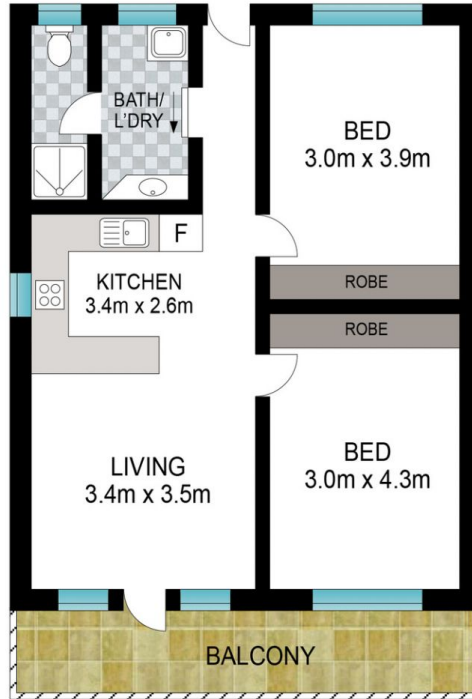
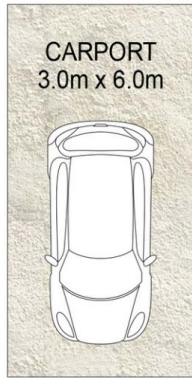

INT: 62 m<sup>2</sup>  
EXT: 8 m<sup>2</sup>

Scale in metres. Indicative only. Dimensions are approximate. All information contained herein is gathered from sources we believe to be reliable. However, we cannot guarantee its accuracy and interested persons should rely on their own enquiries.

4/35 Sandy Beach Road, Korora

